

Lamp Type: G64T5LCA/4CI

Spec Number:

Engineering Specification Sheet

2530

Lamp Diagram:

Four Pin Circuit Interrupt Lamp

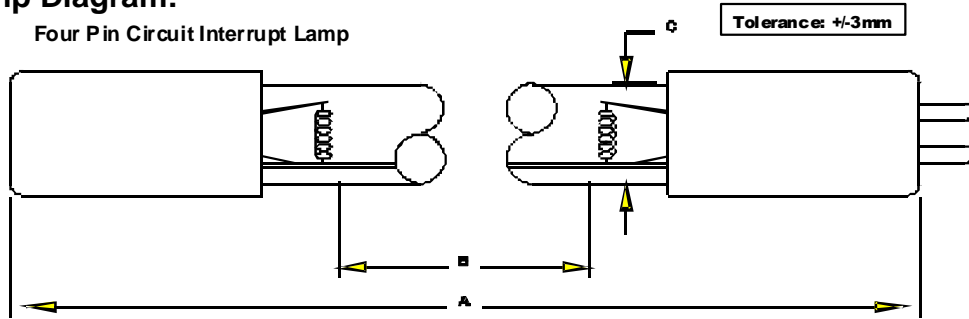

A08-62-C00 HD No Hole Base

Left Base Diagram:

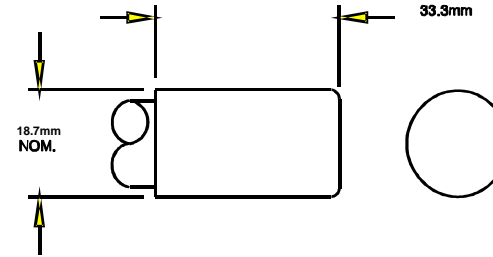

A08-38-CP0 Circuit Interrupt Base

Right Base Diagram:

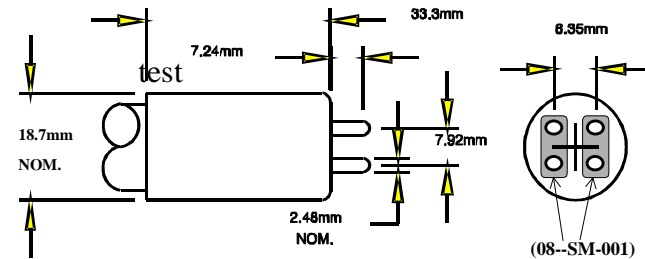

Pin: 08-PN-009

Lamp Characteristics

(A) Base Face: 1554 mm
 (B) ARC: 1478mm
 (C) Bulb Diameter: 15
 (X) _____
 Glass Type: L (Non-Ozone) Coating: A11-QC-001
 Operating Current: 450mA
 Lamp Voltage: 170V
 Lamp Wattage: 75W
 If Spliced: L _____ mm VH _____ mm
 (Y) _____



UV Output

Output UVC Watts	Output μ /cm ² @ 1 Meter	Rated Life (hrs)	% Output @EOL	Output Notes Field	Ballast Used for Measurements
33	240	12000	80.00%		REL-2P60-S

First Light
 PO Box 191, 212 Ideal Way
 Poultney, VT 05764 USA
 Phone-(802) 287-4195 Fax-(802) 287-4489
 www.firstlightusa.com
 email: sales@firstlightusa.com

*UV Output is based on lamps measured after 100 hours of operation under lab conditions. These values are subject to wide variations under application/field conditions.

UV Output is measured at 254 nm

**Rated Life is for reference purposes only and is based on a group of lamps operating under lab conditions. Actual life depends on the operating conditions of the lamp.

12/20/2011

1:41:49 PM