

Lamp Type: GPH279T5LCA/VB-032
Model A

Spec Number:
2954

Engineering Specification Sheet

Lamp Diagram:
UV Max Replacement Lamp

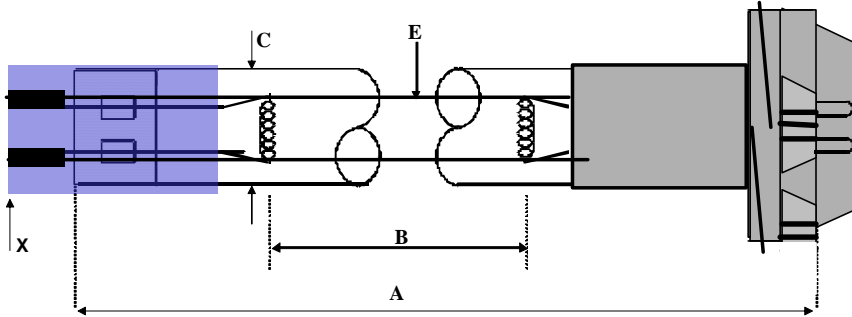

Left Base Diagram:

Lamp Characteristics

(A) Base Face: 279 mm +/- 3mm
 (B) ARC: 217mm
 (C) Bulb Diameter: 15
 (X) See G3
 Glass Type: L (Non-Ozone) Coating: A11-QC-001
 Operating Current: 410mA
 Lamp Voltage: 40V
 Lamp Wattage: 16.4W
 If Spliced: L _____ mm VH _____ mm
 (Y) _____ mm



A08-32-VP0 UV Max Valox Base

Right Base Diagram:

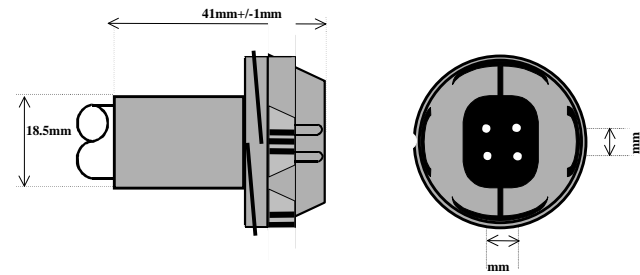

UV Output

| Output UVC Watts | Output μ /cm ² @ 1 Meter | Rated Life (hrs) | % Output @EOL | Output Notes Field | Ballast Used for Measurements |
|------------------|---|------------------|---------------|--------------------|-------------------------------|
| 4 | 40 | 12000 | 80.00% | | SSGPH287 |

First Light
 PO Box 191, 212 Ideal Way
 Poultney, VT 05764 USA
 Phone-(802) 287-4195 Fax-(802) 287-4489
 www.firstlightusa.com
 email: sales@firstlightusa.com

*UV Output is based on lamps measured after 100 hours of operation under lab conditions. These values are subject to wide variations under application/field conditions.
 UV Output is measured at 254 nm
 **Rated Life is for reference purposes only and is based on a group of lamps operating under lab conditions. Actual life depends on the operating conditions of the lamp.

12/20/2011
1:43:00 PM

This data includes matters which are trade secrets of First Light Technologies, Inc., or Proprietary or Confidential to First Light Technologies, Inc. and shall not be reproduced or disclosed in whole or part, or used in any manner except in connection with First Light Technologies, Inc. business, without the written permission of First Light Technologies, Inc.