

Lamp Type: GPH631T5LCA/HO/VB-032

Spec Number:

Engineering Specification Sheet

2956

Lamp Diagram:
UV Max Replacement Lamp

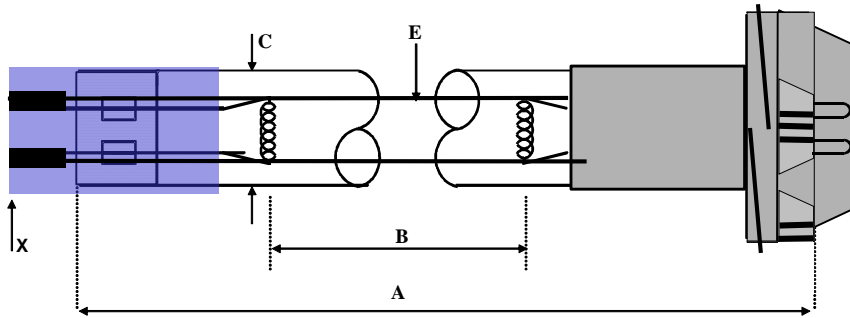

Left Base Diagram:

Lamp Characteristics

(A) Base Face:	631 mm	+/- 3mm		
(B) ARC:	569mm		Operating Current	869mA
(C) Bulb Diameter	15		Lamp Voltage	78V
(X) See G3			Lamp Wattage	68W
Glass Type:	L (Non-Ozone)	Coating:	A11-QC-001	
If Spliced:	L	mm	VH	mm
(Y)	Shrink line put on G4			



A08-32-VP0 UV Max Valox Base

Right Base Diagram:

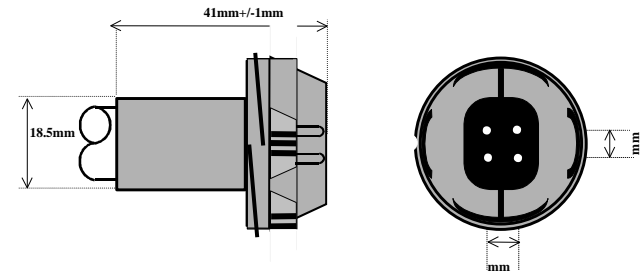

UV Output - Certified to be true. Kenneth A. Ell, President

Output UVC Watts	micro/watt	/cm ² @ 1 Meter	Rated Life (hrs)	% Output @EOL	Output Notes Field	Ballast Used for Measurements
25		220	12000	80.00%		PSP2GPH40HO

First Light
212 Ideal Way
Poultney, VT 05764 USA
Phone-(802) 287-4195 Fax-(802) 287-4489
www.firstlightusa.com
email: sales@firstlightusa.com

*UV Output is based on lamps measured after 100 hours of operation under lab conditions. These values are subject to wide variations under application/field conditions.
UV Output is measured at 254 nm
**Rated Life is for reference purposes only and is based on a group of lamps operating under lab conditions. Actual life depends on the operating conditions of the lamp.

7/3/2018
12:09:55 PM

This data includes matters which are trade secrets of First Light Technologies, Inc., or Proprietary or Confidential to First Light Technologies, Inc. and shall not be reproduced or disclosed in whole or part, or used in any manner except in connection with First Light Technologies, Inc. business, without the written permission of First Light Technologies, Inc.