

Lamp Type: GPH279T5VHCA/VB-032
 Model A in VH

Spec Number:
 3106

Engineering Specification Sheet

Lamp Diagram:
 UV Max Replacement Lamp

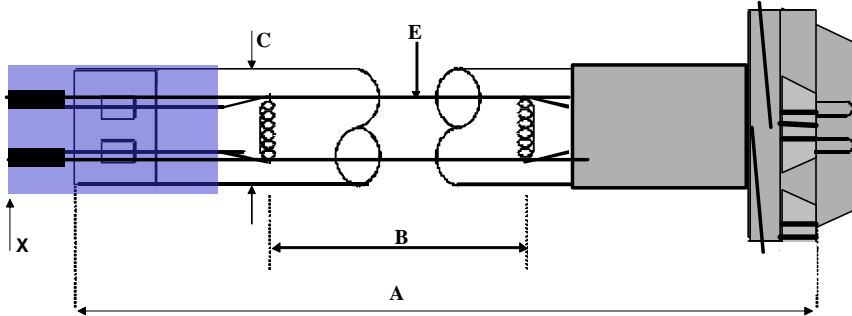

Left Base Diagram:

Lamp Characteristics

(A) Base Face: 279 mm +/- 3mm
 (B) ARC: 217mm
 (C) Bulb Diameter: 15
 (X) See G3
 Glass Type: VH (Ozone) Coating: A11-QC-001
 Operating Current: 410mA
 Lamp Voltage: 40V
 Lamp Wattage: 16.4W
 If Spliced: L _____ mm VH _____ mm
 (Y) _____



A08-32-VP0 UV Max Valox Base

Right Base Diagram:

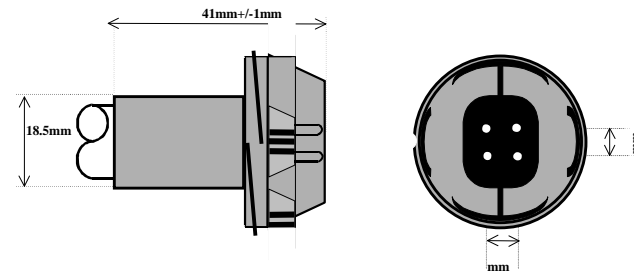

UV Output

Output UVC Watts	Output μ /cm ² @ 1 Meter	Rated Life (hrs)	% Output @EOL	Output Notes Field	Ballast Used for Measurements
4	40	12000	80.00%		SSGPH287

First Light
 PO Box 191, 212 Ideal Way
 Poultney, VT 05764 USA
 Phone-(802) 287-4195 Fax-(802) 287-4489
 www.firstlightusa.com
 email: sales@firstlightusa.com

*UV Output is based on lamps measured after 100 hours of operation under lab conditions. These values are subject to wide variations under application/field conditions.

UV Output is measured at 254 nm

**Rated Life is for reference purposes only and is based on a group of lamps operating under lab conditions. Actual life depends on the operating conditions of the lamp.

12/20/2011

1:44:29 PM