

Lamp Type: GPH226T5VHCA/HO/VB-032  
 Model B in VH

Spec Number:  
 3107

Engineering Specification Sheet

**Lamp Diagram:**  
 UV Max Replacement Lamp

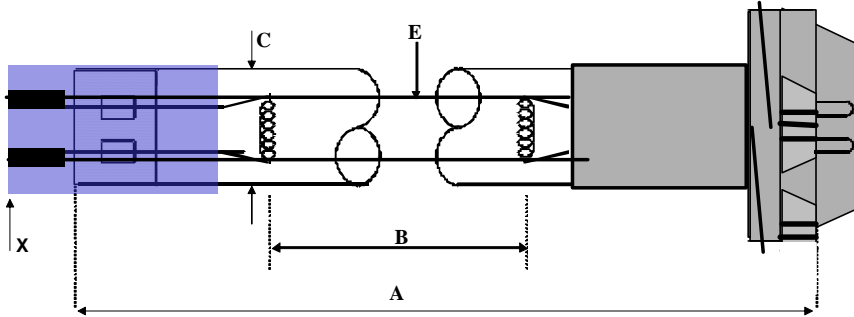

**Left Base Diagram:**

**Lamp Characteristics**

(A) Base Face: 226 mm +/- 3mm  
 (B) ARC: 164mm  
 (C) Bulb Diameter: 15  
 (X) See G3  
 Glass Type: VH (Ozone) Coating: A11-QC-001  
 Operating Current: 850mA  
 Lamp Voltage: 26V  
 Lamp Wattage: 22W  
 If Spliced: L \_\_\_\_\_ mm VH \_\_\_\_\_ mm  
 (Y) \_\_\_\_\_



**A08-32-VP0 UV Max Valox Base**

**Right Base Diagram:**

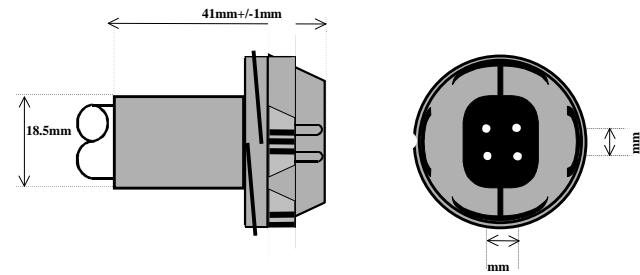

**UV Output**

Output UVC Watts	Output $\mu$ /cm <sup>2</sup> @ 1 Meter	Rated Life (hrs)	% Output @EOL	Output Notes Field	Ballast Used for Measurements
8	70	12000	80.00%		PSP2GPH40HO

**First Light**  
 PO Box 191, 212 Ideal Way  
 Poultney, VT 05764 USA  
 Phone-(802) 287-4195 Fax-(802) 287-4489  
 www.firstlightusa.com  
 email: sales@firstlightusa.com

\*UV Output is based on lamps measured after 100 hours of operation under lab conditions. These values are subject to wide variations under application/field conditions.  
 \*\*\*UV Output is measured at 254 nm\*\*\*  
 \*\*Rated Life is for reference purposes only and is based on a group of lamps operating under lab conditions. Actual life depends on the operating conditions of the lamp.

12/20/2011  
 1:48:38 PM

This data includes matters which are trade secrets of First Light Technologies, Inc., or Proprietary or Confidential to First Light Technologies, Inc. and shall not be reproduced or disclosed in whole or part, or used in any manner except in connection with First Light Technologies, Inc. business, without the written permission of First Light Technologies, Inc.