

Lamp Type: GPH389T5VHCA/HO/VB-032  
 Model C&D in VH 602828

Spec Number:  
 3108

*Engineering Specification Sheet*

**Lamp Diagram:**  
 UV Max Replacement Lamp

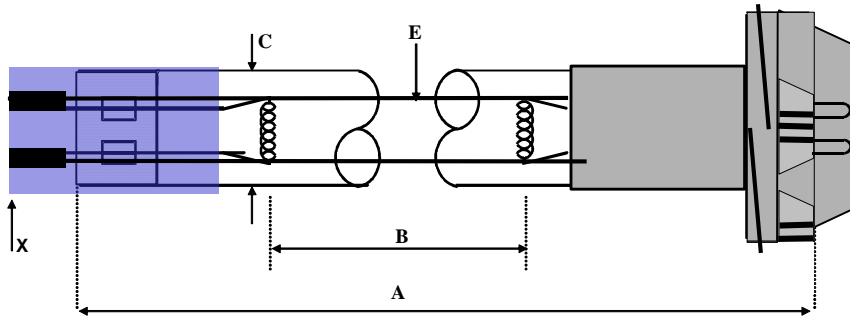

**Left Base Diagram:**

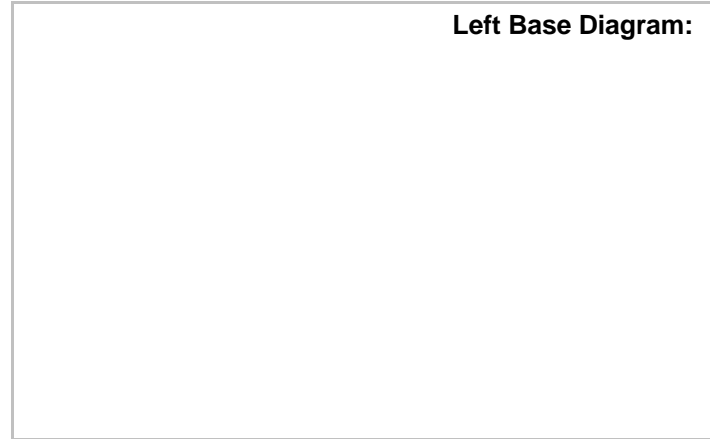

**Lamp Characteristics**

(A) Base Face:	389	mm		
(B) ARC:	308	mm	Operating Current	863mA
(C) Bulb Diameter	15	mm	Lamp Voltage	46.5V
(X)			Lamp Wattage	40W
Glass Type:	VH (Ozone)	Coating:	A11-QC-001	
<b>If Spliced:</b>	L	mm	VH	mm
	(Y)			



**A08-32-VP0 UV Max Valox Base**

**Right Base Diagram:**

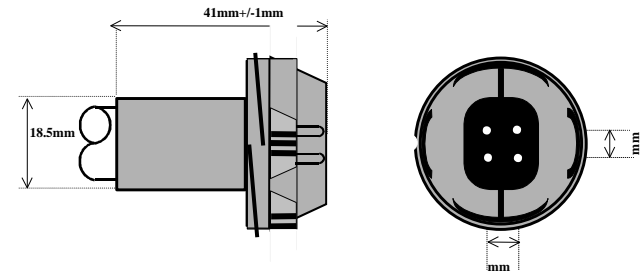

**UV Output - Certified to be true. Kenneth A. Ell, President**

Output UVC Watts	micro/watt	/cm <sup>2</sup> @ 1 Meter	Rated Life (hrs)	% Output @EOL	Output Notes Field	Ballast Used for Measurements
15		135	12000	80.00%		PSP2GPH40HO

**First Light**  
 212 Ideal Way  
 Poultney, VT 05764 USA  
 Phone-(802) 287-4195 Fax-(802) 287-4489  
 www.firstlightusa.com  
 email: sales@firstlightusa.com

\*UV Output is based on lamps measured after 100 hours of operation under lab conditions. These values are subject to wide variations under application/field conditions.  
 \*\*\*UV Output is measured at 254 nm\*\*\*  
 \*\*Rated Life is for reference purposes only and is based on a group of lamps operating under lab conditions. Actual life depends on the operating conditions of the lamp.

7/3/2018  
 12:14:51 PM

This data includes matters which are trade secrets of First Light Technologies, Inc., or Proprietary or Confidential to First Light Technologies, Inc. and shall not be reproduced or disclosed in whole or part, or used in any manner except in connection with First Light Technologies, Inc. business, without the written permission of First Light Technologies, Inc.