

Lamp Type: GPH631T5VHCA/HO/VB-032
 Model E in VH 602829

Spec Number:
 3109

Lamp Diagram:
 UV Max Replacement Lamp

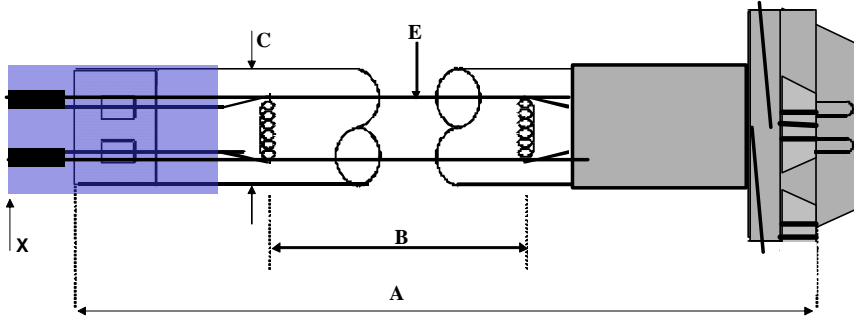

Left Base Diagram:

Lamp Characteristics

(A) Base Face: 631 mm +/- 3mm
 (B) ARC: 569mm
 (C) Bulb Diameter: 15
 (X) See G3
 Glass Type: L (Non-Ozone) Coating: A11-QC-001
 Operating Current: 869mA
 Lamp Voltage: 78V
 Lamp Wattage: 68V
 If Spliced: L mm VH mm
 (Y) mm



A08-32-VP0 UV Max Valox Base

Right Base Diagram:

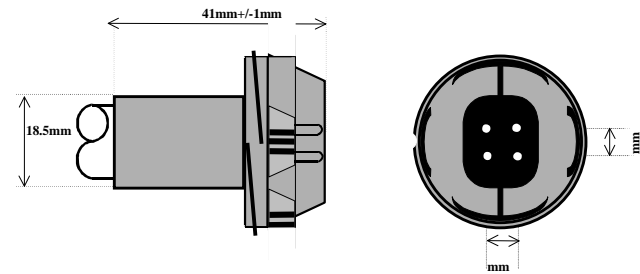

UV Output

Output UVC Watts	Output μ /cm ² @ 1 Meter	Rated Life (hrs)	% Output @EOL	Output Notes Field	Ballast Used for Measurements
25	220	12000	80.00%		PSP2GPH40HO

First Light
 PO Box 191, 212 Ideal Way
 Poultney, VT 05764 USA
 Phone-(802) 287-4195 Fax-(802) 287-4489
 www.firstlightusa.com
 email: sales@firstlightusa.com

*UV Output is based on lamps measured after 100 hours of operation under lab conditions. These values are subject to wide variations under application/field conditions.
 UV Output is measured at 254 nm
 **Rated Life is for reference purposes only and is based on a group of lamps operating under lab conditions. Actual life depends on the operating conditions of the lamp.

12/20/2011
 1:49:01 PM